

## CONTROL VALVE

### 58000 SERIES

The Control Valve is an integral part of the DCD blowing system. A ball valve allows control of air flow and quick disconnect fittings are attached both ends. Three Rope Guides are included with each Control Valve purchased.

Part No.	Description	Weight
58000-000	CONTROL VALVE C/W ROPE GUIDES	2.47 LB
58000-188	ROPE GUIDE - 3/16"	0.10 LB
58000-250	ROPE GUIDE - 1/4"	0.10 LB
58000-375	ROPE GUIDE - 3/8"	0.04 LB



The Control Valve Adapter allows connection of the Control Valve to the 58420 Seal Off Adapters.

Part No.	Description	Weight
58000-100	CONTROL VALVE - SEAL OFF ADAPTER	4.0 LB



## INNERDUCT SEALS

### 58100 SERIES

DCD offers two types of seals. The Innerduct Seal is a screw-in type that requires one product for each duct size. The second type is a Universal Seal which is a tapered product suitable for all duct sizes from 1" to 2". This is for use on short distance blowing where simply holding the seal against the end of the duct will do the job and save time.

The Kit comprises all four Innerduct Seals plus the Universal Seal. A Control Valve and Rope Guides are also included.

Part No.	Description	Nom. Duct Size	Weight
58100-000	UNIVERSAL SEAL	1" - 2"	1.50 LB
58100-100	INNERDUCT SEAL	1"	1.40 LB
58100-125	INNERDUCT SEAL	1-1/4"	2.20 LB
58100-150	INNERDUCT SEAL	1-1/2"	3.02 LB
58100-200	INNERDUCT SEAL	2"	3.96 LB
58150-000	UNIVERSAL KIT C/W CONTROL VALVE, 4 INNERDUCT SEALS & 1 UNIVERSAL SEAL	1" - 2"	18 LB

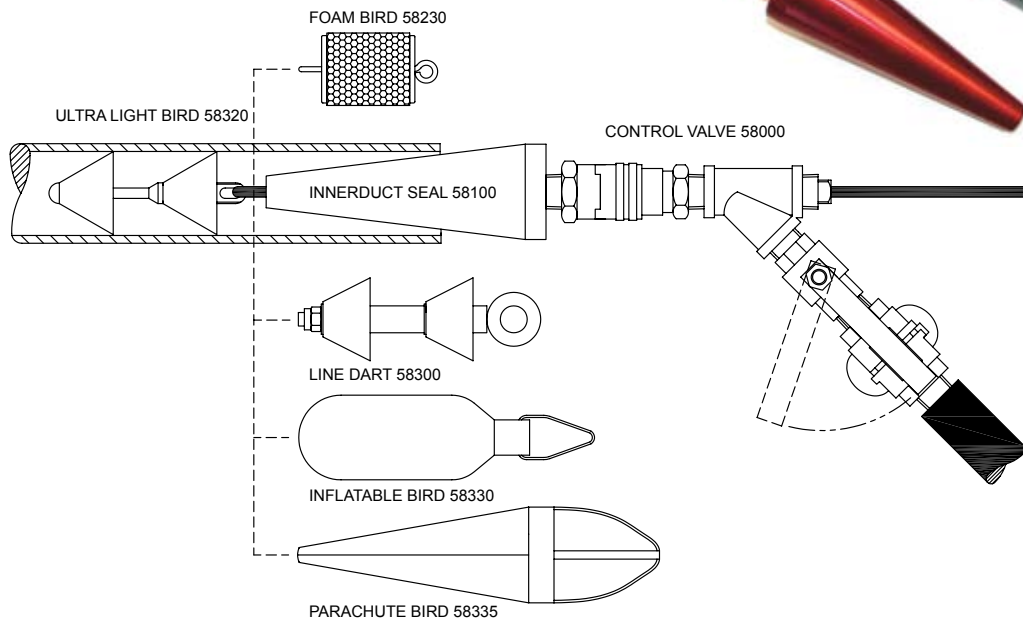

# DUCT SEALS

## 58200 SERIES

Duct Seals are unique for several reasons. The expandable seals are colour coded for easy recognition. They are made from a specially formulated polyurethane designed to give maximum sealing and expansion properties.

While a single seal is difficult to align properly, a double seal is expensive.

The DCD unit has a single seal, but supports it with an alignment washer. Economical but effective. All seal sizes fit over the same Handle Assembly and changing the size of seal used is a breeze. Just unscrew two nuts, slide off one Seal Kit and slide on the next one.

The end of the unit is fitted with a quick release coupling. Each Seal Kit comes complete with the polyurethane seal, two compression washers and one stabilizing washer. Just order the size of seal you need plus one Handle Assembly. Next time, just order the new size of seal you need.

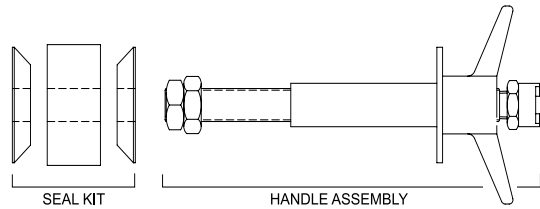

### HANDLE ASSEMBLY

Part No.	Weight
58200-000	3.0 LB

### PLUS

Part No.	Nominal Duct Size	Min Duct Inside Dia.	Max. Duct Inside Dia.	Color Code	*Max. Tested Pressure	Weight
58200-200	2"	1-13/16"	2-5/16"	GREEN	40 PSI.	0.23 LB
58200-250	2-1/2"	2-3/16"	2-3/4"	RED	35 PSI.	0.45 LB
58200-300	3"	2-13/16"	3-3/8"	YELLOW	30 PSI.	0.93 LB
58200-350	3-1/2"	3-1/4"	3-13/16"	WHITE	25 PSI.	1.23 LB
58200-400	4"	3-5/8"	4-1/4"	BLUE	20 PSI.	1.59 LB
58200-500	5"	4-1/2"	5-1/8"	ORANGE	15 PSI.	2.67 LB
58200-600	6"	5-3/8"	6-1/16"	BLACK	10 PSI.	3.81 LB

\* All seals have been tested to at least 15% higher than stated values. The actual pressure attained may depend on the condition of both the duct and the Seal Kit. Care should be taken at all times when working with pressurized systems.

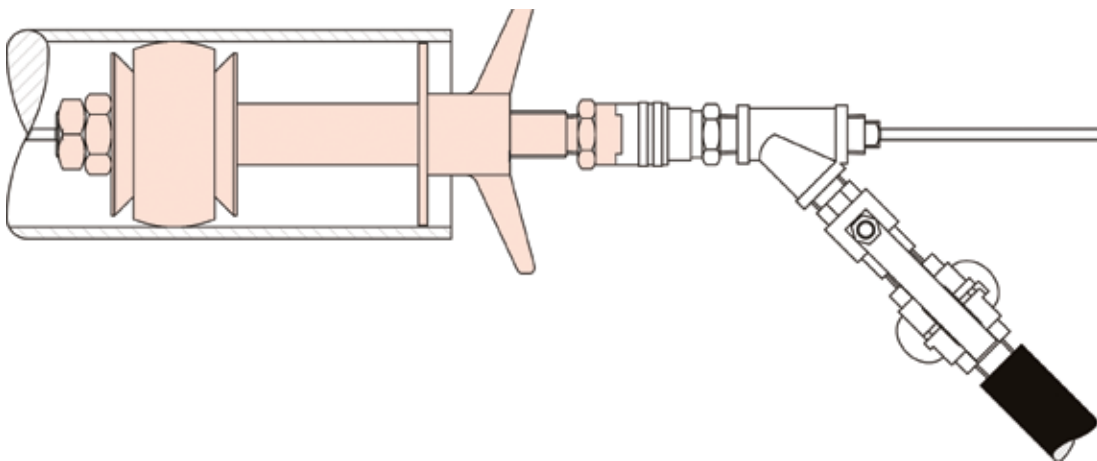

Web Site: [www.dcdesign.com](http://www.dcdesign.com)



Toll Free: 1-888-SWIVELS (794-8357)

Tel: 604-232-4445

Fax: 604-232-4446

E-mail: [sales@dcdesign.com](mailto:sales@dcdesign.com)