

CLEVIS PIN & DETAIL

00000 series

This catalog sheet is intended to provide information on Clevis dimensions not shown on other catalog sheets. This information pertains to all products that use either type of Clevis Pins listed below.

All Clevis Pins are manufactured from heat treated 416 Stainless Steel to provide superior strength and wear. Hardness is between 37-40 Rc.

The DCD Clevis Pin is a shouldered type of pin rather than a simple straight pin without any head. This design greatly improves the strength of the clevis by not allowing side loads to spread the clevis opening. The underside of the head and the end of the shoulder are precision machined such that, when screwed tight, both surfaces contact simultaneously and therefore lock in place. Tensile loads are carried by the body or 'C' diameter of the pin since it is this diameter that locates in both sides of the clevis and therefore no tensile load is carried by the thread.

The hardened Clevis Pin also resists wear much better than conventional Clevis Pins. During operation there is a constant rubbing between the surface of the Clevis Pin and the attached item. A hard surface decreases the wear on the pin as well as increasing the strength of the pin.

Finally, the larger diameter of the shoulder will decrease wear on the attached item. If this happened to be a wire rope, for example, a conventional pin would cause that rope to bend in a very tight radius, affecting the life of each strand. The larger DCD pins increase that radius and also increase the life of the wire.

Most products 1-1/4" diameter and less are supplied with Slotted Clevis Pins, those greater than 1-1/4" are supplied with Hexagon socket Clevis Pins. This is based on consumer preference. Either Slotted or Hexagon pins are available for most sizes but must be requested at time of ordering if not standard.

Because the DCD Clevis Pin is a precision machined product specifically designed to fit the clevis, field substitution with any other pins is not recommended. Doing so may cause serious danger to operators and equipment and will immediately void any warranty or liability for the product.

All Clevis Pin kits contain 2 pins.

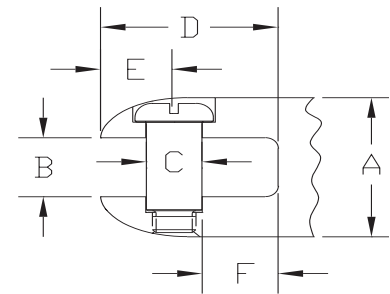

Slotted Pin Kit Part No.	Hexagon Pin Kit Part No.	Hex Key Size	A	B	C	D	E	F
00005-SLT	N/A	N/A	5/8"	9/32"	3/16"	11/16"	1/4"	11/32"
00010-SLT	00010-HEX	7/32"	7/8"	3/8"	5/16"	31/32"	7/16"	3/8"
00015-SLT	00015-HEX	1/4"	1"	13/32"	3/8"	1-3/32"	1/2"	13/32"
00020-SLT	00020-HEX	1/4"	1-1/4"	17/32"	13/32"	1-9/32"	17/32"	9/16"
00025-SLT	00025-HEX	5/16"	1-3/8"	9/16"	1/2"	1-3/8"	5/8"	1/2"
00025-SLT	00025-HEX	5/16"	1-1/2"	19/32"	1/2"	1-9/16"	11/16"	5/8"
00030-SLT	00030-HEX	3/8"	1-5/8"	11/16"	5/8"	1-23/32"	3/4"	21/32"
00035-SLT	00035-HEX	3/8"	2"	25/32"	11/16"	2-1/16"	15/16"	25/32"
NA	00037-HEX	3/8"	2-1/4"	7/8"	3/4"	2-3/8"	1-1/8"	3/4"
N/A	00040-HEX	3/8"	2-3/8"	1-1/32"	7/8"	2-25/32"	1-3/16"	1-5/32"
N/A	00045-HEX	3/8"	3"	1-3/16"	1-1/8"	3-5/8"	1-1/2"	1-9/16"
N/A	00050-HEX	1/2"	3-3/4"	1-1/2"	1-1/4"	4-1/4"	1-7/8"	1-3/4"

Darker shaded part numbers indicate standard Clevis Pin type supplied in most products.

Web Site: www.dcdesign.com
E-mail: sales@dcdesign.com

Toll Free: 1-888-SWIVELS (794-8357)
Tel: 604-232-4445
Fax: 604-232-4446

SWIVELS & CONNECTORS

DCD