

OPERATING SPECIFICATIONS

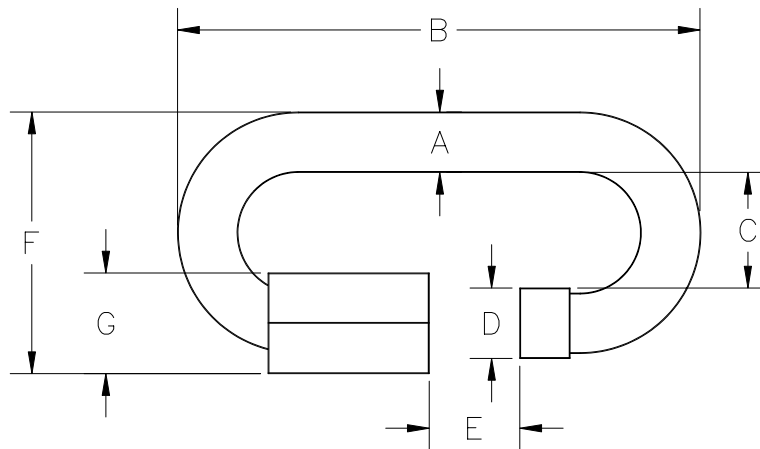

SERIES 00660 QUICK LINK CONNECTOR

1. The quick link connector is intended for temporary connections between pieces of Grade 30 chain.
2. The connector is not to be used for overhead lifting!



Part Number	Safe Working Limit	Ultimate Load	A	B	C	D	E	F	G	Net Weight
00660-187	660 lb 2.9 kN	1,320 lb 5.9 kN	3/16" 5 mm	2" 51 mm	1/2" 12.5 mm	1/4" 6 mm	1/4" 6 mm	1" 25 mm	3/8" 9 mm	0.045 lb 0.020 kg
00660-250	880 lb 3.9 kN	1,760 lb 7.8 kN	1/4" 6 mm	2-3/8" 60 mm	1/2" 12.5 mm	3/8" 9 mm	5/16" 8 mm	1-1/8" 28 mm	7/16" 11 mm	0.079 lb 0.036 kg
00660-312	1,760 lb 7.8 kN	3,520 lb 16 kN	5/16" 8 mm	3" 75 mm	5/8" 16 mm	13/32" 10.5 mm	3/8" 9.5 mm	1-7/16" 36 mm	9/16" 14 mm	0.17 lb 0.077 kg
00660-375	2,200 lb 9.8 kN	4,400 lb 20 kN	3/8" 9 mm	3-3/16" 81 mm	11/16" 17 mm	15/32" 12 mm	7/16" 11 mm	1-9/16" 40 mm	19/32" 15 mm	0.24 lb 0.11 kg
00660-437	2,600 lb 12 kN	5,200 lb 23 kN	7/16" 10 mm	3-1/2" 90 mm	3/4" 19 mm	1/2" 12.5 mm	15/32" 12 mm	1-11/16" 43 mm	5/8" 16 mm	0.29 lb 0.13 kg
00660-500	3,300 lb 15 kN	6,600 lb 29 kN	1/2" 12 mm	4-1/8" 105 mm	7/8" 22 mm	9/16" 14 mm	9/16" 14 mm	2" 51 mm	3/4" 19 mm	0.50 lb 0.23 kg

Dimensions and weights subject to change without notice.

The **Safe Working Limit** is calculated using a 2:1 safety factor based on the ultimate load.

The **Ultimate Load** is the tensile load required to separate the connector into two or more parts.