

# OPERATING SPECIFICATIONS

## **DCD** Design & Manufacturing Ltd.

### SERIES 00550 BREAKAWAY SWIVEL

1. The swivel is intended as mechanical overload protection for use when installing fiber optic cable. It is used in conjunction with series 00535 or 00555 breakaway pins.
2. **The swivel is not designed to run around bull wheels.**

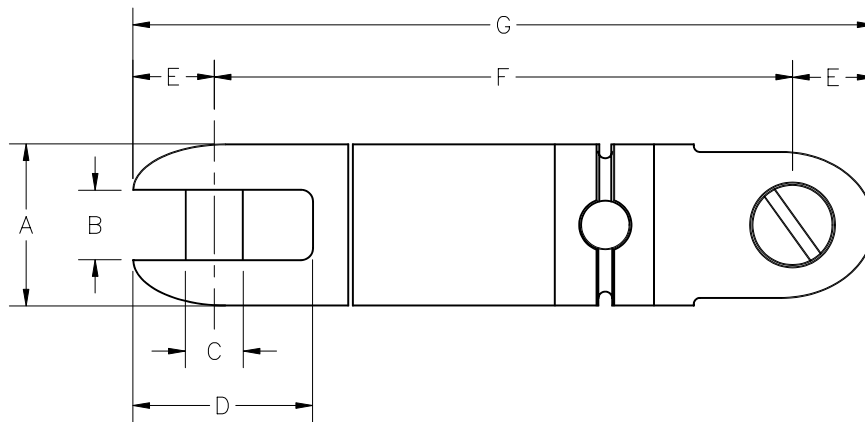

Part Number	A	B	C	D	E	F	G	Net Weight
<b>00550-005</b>	5/8" 16 mm	9/32" 7.1 mm	3/16" 4.8 mm	11/16" 17.5 mm	1/4" 6.4 mm	2-3/4" 70 mm	3-1/4" 83 mm	0.17 lb 0.08 kg
<b>00550-010</b>	7/8" 22 mm	3/8" 9.5 mm	5/16" 7.9 mm	31/32" 24.6 mm	7/16" 11.1 mm	3-3/16" 81 mm	4-1/16" 103 mm	0.42 lb 0.19 kg
<b>00550-020</b>	1-1/4" 32 mm	17/32" 13.5 mm	13/32" 10.3 mm	1-9/32" 32.5 mm	17/32" 13.5 mm	4-1/2" 114 mm	5-9/16" 141 mm	1.2 lb 0.55 kg

Dimensions and weights subject to change without notice.

# OPERATING INSTRUCTIONS

# DCD

## Design & Manufacturing Ltd.

### SERIES 00550 BREAKAWAY SWIVEL



READ AND UNDERSTAND  
THESE INSTRUCTIONS  
BEFORE USING  
THESE PRODUCTS

## INSTALLATION

1. Remove the split ring and insert the breakaway head into the bore in the breakaway body. Align the hole through the body with the hole through the head.

2. Select a breakaway pin with the appropriate breaking strength and insert into the connector.

3. Replace the split ring to retain the pin in place.

4. Use a new breakaway pin for each pullback.

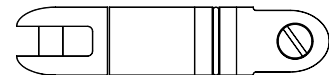
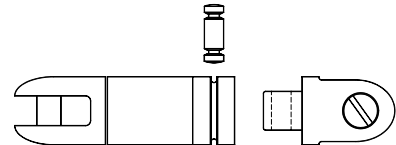

## SAFETY



1. The breakaway swivel is not designed to be pulled over sheaves or bullwheels since a bending load acts to increase the tension in the swivel and may cause damage.

2. Never use a worn, defective or incomplete component. Ensure that all components of the pulling system are able to withstand the maximum pulling loads. Components not rated for the pull force may break and release the stored energy of the pull.

3. Do not modify the swivel. It is only covered by a warranty in its "as shipped" form. Any attempt to modify the swivel will void the warranty and may result in property damage, severe bodily harm, or death.

4. Be prepared for the unexpected. Use recognized safety practices and wear recognized safety equipment.

## SERVICE



1. After each use, examine the condition of the swivel. Replace worn or bent clevis pins with original equipment manufacturer's pins.